

一日立 日-D-タイプ (DELNP-K) モーター銘板

EC-21

3V402 E3 JE VDE仕様

1/3

Note (注記)

- #01.....For type - E - Eタイプ用
- #02.....For type - E2 - E2タイプ用
- #03.....1J402-E-E2, 1D402-E-E2, 1J404-E-E2, 1D404-E-E2
- #04.....1J254-E-E2, 1D254-E-E2
- #05.....3J402-E-E2
- #06.....3D402-E-E2
- #07.....1J402-E-E2
- #08.....1D402-E-E2
- #09.....3J254-E-E2
- #10.....3D254-E-E2
- #11.....1J254-E-E2
- #12.....1D254-E-E2
- #13.....3J404-E-E2
- #14.....3D404-E-E2
- #15.....1J404-E-E2
- #16.....1D404-E-E2
- #17.....3J552-E-E2
- #18.....3D552-E-E2
- #19.....1J552-E-E2
- #20.....1D552-E-E2
- #21.....3J402-E-E2, 3D402-E-E2, 3J552-E-E2, 3D552-E-E2
- #22.....1J402-E-E2, 1D402-E-E2, 1J552-E-E2, 1D552-E-E2
- #23.....3J254-E-E2, 3D254-E-E2
- #24.....3J404-E-E2, 3D404-E-E2
- #25.....1J404-E-E2, 1D404-E-E2
- #26.....For 3 phase type - E 3相-Eタイプ用
- #27.....For 1 phase type - E 単相-Eタイプ用
- #28.....For 3 phase type - E2 3相-E2タイプ用
- #29.....For 1 phase type - E2 単相-E2タイプ用
- #30.....For 1 phase type - E-E2 単相-E-E2タイプ用

| Model 形式 | Phase 相 | Out put 出力 | Pole 極数 | Voltage 電圧 | Remarks 備考 |
|-------------|------------|---------------|------------|-------------------|-------------------------|
| 3J402-E-E2 | 3 | 400W | 2P | 200V | For domestic use 国内用 |
| 3D402-E-E2 | 3 | 400W | 2P | 220-250V/380-440V | For export standard 輸出用 |
| 3J404-E-E2 | 3 | 400W | 4P | 200V | For domestic use 国内用 |
| 3D404-E-E2 | 3 | 400W | 4P | 220-250V/380-440V | For export standard 輸出用 |
| 3J254-E-E2 | 3 | 250W | 4P | 200V | For domestic use 国内用 |
| 3D254-E-E2 | 3 | 250W | 4P | 220-250V/380-440V | For export standard 輸出用 |
| 3J552-E-E2 | 3 | 550W | 2P | 200V | For domestic use 国内用 |
| 3D552-E-E2 | 3 | 550W | 2P | 220-250V/380-440V | For export standard 輸出用 |
| 1J402-E-E2 | 1 | 400W | 2P | 100V | For domestic use 国内用 |
| 1D402-E-E2 | 1 | 400W | 2P | 110-125V/220-250V | For export standard 輸出用 |
| 1J404-E-E2 | 1 | 400W | 4P | 100V | For domestic use 国内用 |
| 1D404-E-E2 | 1 | 400W | 4P | 110-125V/220-250V | For export standard 輸出用 |
| 1J254-E-E2 | 1 | 250W | 4P | 100V | For domestic use 国内用 |
| 1D254-E-E2 | 1 | 250W | 4P | 110-125V/220-250V | For export standard 輸出用 |
| 1J552-E-E2 | 1 | 550W | 2P | 100V | For domestic use 国内用 |
| 1D552-E-E2 | 1 | 550W | 2P | 110-125V/220-250V | For export standard 輸出用 |

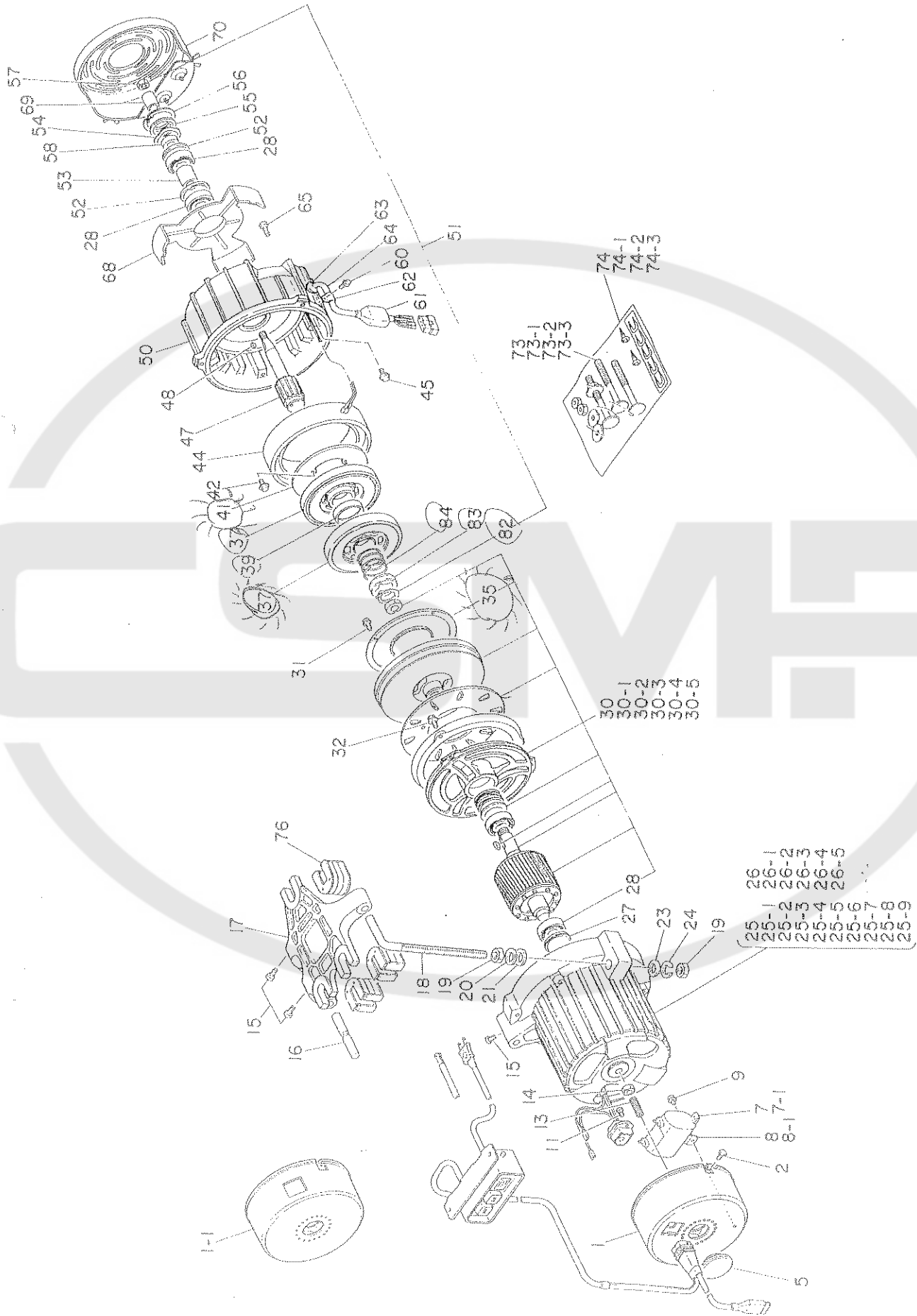

- 25-1
- 25-2
- 25-3
- 25-4
- 25-5
- 25-6
- 25-7
- 25-8
- 25-9
- 26-1
- 26-2
- 26-3
- 26-4
- 26-5
- 26-6

- 30-1
- 30-2
- 30-3
- 30-4
- 30-5

- 73-1
- 73-2
- 73-3

- 74-1
- 74-2
- 74-3

D type HITACHI ELECTRO NEEDLE POSITIONING MOTOR

3/3

| Ref.No | Note | Part No. | Description | Amt. Req. |
|--------|------|---------------------|--------------------------------|-----------|
| 1 | #01 | MTS-H0016210 | END COVER | 1 |
| 1-1 | #02 | MTS-H3949038 | END COVER ASM. | 1 |
| 2 | | MTS-H4554541 | COVER BOLT M5x3 | 2 |
| 5 | | MTS-H4879431 | RUBBER CAP | 1 |
| 7 | #03 | MTS-H3913153 | CAPACITOR 35uF | 1 |
| 7-1 | #04 | MTS-H3917152 | CAPACITOR 20uF | 1 |
| 8 | #03 | MTS-H4879411 | CAPACITOR BAND | 1 |
| 8-1 | #04 | MTS-H4877351 | CAPACITOR BAND | 1 |
| 9 | | SM-4051001-SF | SCREW M5x0.8 L=10 | 1 |
| 11 | | SM-4040801-SF | SCREW M4x0.7 L=8 | 2 |
| 13 | | MTS-H0016116 | SCREW M10 | 1 |
| 14 | | NM-6100002-SF | NUT M10 | 1 |
| 15 | | SM-4051201-SF | SCREW M5 L=12 | 3 |
| 16 | | MTS-H0016068 | BASE SHAFT | 1 |
| 17 | | MTS-H0016208 | BASE | 1 |
| 18 | | MTS-H4520762 | ADJUSTEMENT BOLT | 1 |
| 19 | | NM-6100001-SF | NUT M10 | 2 |
| 20 | | MTS-H0014587 | WASHER (A) | 1 |
| 21 | | MTS-H0014588 | WASHER (B) | 1 |
| 23 | | WS-1022502-K0 | SPRING WASHER M10 | 1 |
| 24 | | WP-1052001-SF | WASHER M10 | 1 |
| 25 | #05 | MTS-H236754A | HOUSING ASM. | 1 |
| 25-1 | #06 | MTS-H236754B | HOUSING ASM. | 1 |
| 25-2 | #07 | MTS-H235944A | HOUSING ASM. | 1 |
| 25-3 | #08 | MTS-H235944B | HOUSING ASM. | 1 |
| 25-4 | #09 | MTS-H236755A | HOUSING ASM. | 1 |
| 25-5 | #10 | MTS-H236755B | HOUSING ASM. | 1 |
| 25-6 | #11 | MTS-H2A0425A | HOUSING ASM. | 1 |
| 25-7 | #12 | MTS-H2A0425B | HOUSING ASM. | 1 |
| 25-8 | #13 | MTS-H2A0381A | HOUSING ASM. | 1 |
| 25-9 | #14 | MTS-H2A0381B | HOUSING ASM. | 1 |
| 26 | #15 | MTS-H2A0427A | HOUSING ASM. | 1 |
| 26-1 | #16 | MTS-H2A0427B | HOUSING ASM. | 1 |
| 26-2 | #17 | MTS-H236754A | HOUSING ASM. | 1 |
| 26-3 | #18 | MTS-H236754B | HOUSING ASM. | 1 |
| 26-4 | #18 | MTS-H2A0426A | HOUSING ASM. | 1 |
| 26-5 | #20 | MTS-H2A0426B | HOUSING ASM. | 1 |
| 27 | | MTS-H45872.1 | GAP ADJUSTMENT CAP | 1 |
| 28 | | MTS-H0014224 | BALL BEARING | 4 |
| 30 | #21 | MTS-H3A0825A | ROTOR ASM. | 1 |
| 30-1 | #22 | MTS-H3A0826A | ROTOR ASM. | 1 |
| 30-2 | #23 | MTS-H3A0827A | ROTOR ASM. | 1 |
| 30-3 | #04 | MTS-H3A0828A | ROTOR ASM. | 1 |
| 30-4 | #24 | MTS-H3A0829A | ROTOR ASM. | 1 |
| 30-5 | #25 | MTS-H3A0830A | ROTOR ASM. | 1 |
| 31 | | MTS-H7900101 | SCREW M5 L=12 | 4 |
| 32 | | SL-4051681-SF | SCREW M5=16 | 3 |
| 35 | | MTS-H0016205 | CLUTCH DISK | 1 |
| 37 | | MTS-H0016102 | CLUTCH RING ASM. | 2 |
| 39 | | MTS-H0016221 | SPLING CAP | 1 |
| 41 | | MTS-H0016204 | BRAKE DISK | 1 |
| 42 | | SL-4041241-SF | SCREW M4x12 | 3 |
| 44 | | MTS-H0016203 | CLUTCH YOKE | 1 |
| 45 | | SL-4031371-SF | SCREW M5 L=16 | 3 |
| 47 | | MTS-H483373A | CLUTCH SHAFT | 1 |
| 48 | | MTS-H0016117 | SEMI-CIRCULAR KEY 4x13 | 1 |
| 50 | | MTS-H035945A | PULLEY SIDE BRACKET ASM. | 1 |
| 51 | | MTS-H112685A | CLUTCH HEAD ASM. | 1 |
| 52 | | MTS-H0016115 | RUBBER RING | 2 |
| 53 | | MTS-H4469111 | COLLAR | 1 |
| 54 | | MTS-H0014418 | SPRING | 1 |
| 55 | | MTS-H4345281 | WASHER | 1 |
| 56 | | MTS-H3800101 | RETAINING RING 40 | 1 |
| 57 | | MTS-H4537401 | NUT M10 | 1 |
| 58 | | MTS-H4379421 | COLLAR | 1 |
| 60 | | SL-4041091-SF | SCREW M4x10 | 1 |
| 61 | | MTS-H4410861 | CONNECTOR COVER | 1 |
| 62 | | MTS-H4257803 | CLIP | 1 |
| 63 | | MTS-H4258231 | RUBBER BUSHING | 1 |
| 64 | | MTS-H2224680 | TUBE | 1 |
| 65 | | MTS-H487652A | SCREW M6 L=25 | 3 |
| 66 | | MTS-H395272A | PULLEY SIDE BRACKET COVER ASM. | 1 |
| 69 | | MTS-H2224751 | TUBE | 1 |
| 70 | | MTS-H395289A | PULLEY COVER ASM. | 1 |
| 73 | #26 | MTS-H444898A | BOLT | 3 |
| 73-1 | #27 | MTS-H410586A | BOLT | 3 |
| 73-2 | #28 | MTS-H477603A | MOUNTING BOLT | 3 |
| 73-3 | #29 | MTS-H477605B | MOUNTING BOLT | 3 |
| 74 | #26 | MTS-H001612C | ACCESSORIES FOR SETTING | 1 |
| 74-1 | #27 | MTS-H0016216 | ACCESSORIES FOR SETTING | 1 |
| 74-2 | #28 | MTS-H378097A | ACCESSORIES FOR SETTING | 1 |
| 74-3 | #29 | MTS-H378097B | ACCESSORIES FOR SETTING | 1 |
| 76 | #30 | MTS-H4584281 | VIBRATION ABSORBER | 3 |
| 82 | | RC-2220001-KP | RETAINING RING 24 | 1 |
| 83 | | MTS-H4551121 | SPRING HOLDER | 1 |
| 84 | | MTS-H4546131 | CLUTCH RETURN SPRING | 1 |